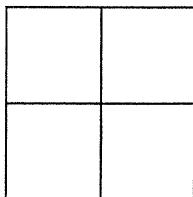

CORNER RECORD

Document Number CR 6191City of BERKELEYCounty of ALAMEDA, CaliforniaBrief Legal Description IRON PIN CITY MONUMENT IN WELL LOCATED WITHIN SAN MIGUEL AVENUE.
(CITY OF BERKELEY: B2464)

CORNER RECORD

COORDINATES
(Optional)

Government Corner ☐ Control ☒
 Meander ☐ Property ☐
 Rancho ☐ Other ☐
 Date of Survey 04/08/2014

N. _____
 E. _____
 Zone _____ Datum _____
 Elev. _____

Corner — Left as found ☒ Found and tagged ☐ Established ☐ Reestablished ☐ Rebuilt ☐

Identification and type of corner found: Evidence used to identify or procedure used to establish or reestablish the corner:
FOUND IRON PIN CITY MONUMENT IN WELL LOCATED WITHIN SAN MIGUEL AVENUE.

(REFERENCE ADDRESS: 602 SAN MIGUEL AVENUE)

THIS POINT WAS REFERENCED PRIOR TO A CONSTRUCTION PROJECT IN THE VICINITY.

A description of the physical condition of the monument as found and as set or reset: _____
FOUND AND SET POINTS AS SHOWN ON PAGE 2.

THE TIES SHOWN HEREON ARE FOR THE PUPOSE OF PERPETUATING FOUND MONUMENTATION.
 NO CLAIM IS MADE AS TO THE RELATIONSHIP OF THE POINTS OR LINES SHOWN HEREON TO
 TRUE BOUNDARY LOCATIONS.

SURVEYOR'S STATEMENT

This Corner Record was prepared by me or under my direction in conformance with

the Land Surveyors' Act on APRIL 22, 20 14.

Signed Vincent H. Cunha L.S. Number L5 4520
 VINCENT H. CUNHA

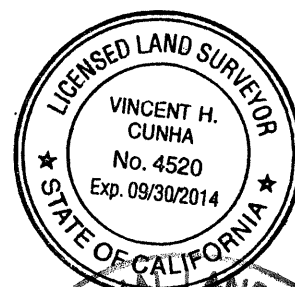

COUNTY SURVEYOR'S STATEMENT

This Corner Record was received 4-29-2014 and examined

and filed 6-6-2014.

Signed Russell R. Penland Title County Surveyor

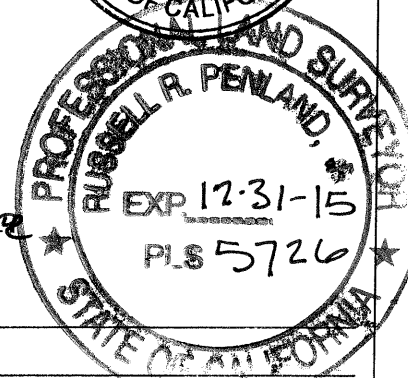

County Surveyor's Comment _____

MF63R1

SCALE : 1"=20'

LEGEND

- FOUND IRON PIN IN MONUMENT WELL
- ✕ SET CUT CROSS IN CONCRETE
- AA##A# ALAMEDA COUNTY MONUMENT ID
- C.O.B. CITY OF BERKELEY

THOUSAND OAKS BOULEVARD

1710 THOUSAND OAKS AVENUE

ELEV=220.47'

28.53'

MF63R1

C.O.B. B2464
ELEV=222.73'

ELEV=222.99'

ELEV=225.20'

24.80'

ELEV=223.98'

602 SAN MIGUEL AVENUE

SAN MIGUEL AVENUE

NOTE

ELEVATIONS SHOWN HEREON ARE BASED UPON
CITY OF BERKELEY VERTICAL DATUM
C.O.B. B2464 TAKEN AS ELEV=222.73'

212037-Q\SAN MIGUEL\CR-1