

OWNERS CERTIFICATE

We hereby certify that we are the owners of, or have some right, title, or interest in and to the real property included within the subdivision shown upon the herein map; that we are the only persons whose consents are necessary to pass a clear title to said real property; that we hereby consent to the preparation and recording of said map and subdivision as shown within the distinctive border line.

We hereby reserve for the benefit of the owners of Parcel A, their licensees, visitors and tenants rights of access and maintenance upon and over that certain strip of land designated as "Access and Maintenance Easement" to existing Water System. All of the herein described streets and easements shall be kept free of buildings, except lawful unsupported roof overhangs, and obstructions that impair the use of or are inconsistent with the purposes of the street or easement.

The herein described offers of dedication to the County of Santa Clara are to be accepted only when the Board of Supervisors or its successor agency adopts and records in the Office of the Recorder of Santa Clara County a resolution accepting said streets or easements. Until said resolutions are recorded, all streets and easements encompassed within such offers of dedication shall be maintained by the developer during any required warranty period and thereafter by the owners of the lots or parcels in the subdivision. The County of Santa Clara shall not be responsible for maintenance and shall incur no liability with respect to such offered streets and easements or any improvement thereon. All dedicated rights of way and easements not accepted for maintenance by the County or other public agency shall be maintained by the owners of the lots or parcels in the subdivision.

OWNERS

Thomas E. Murison
THOMAS E. MURISON
Philip A. Muscara Jr.
PHILIP A. MUSCARA, JR.

Janette L. Murison
JANETTE L. MURISON

STATE OF CALIFORNIA }
COUNTY OF SANTA CLARA } S.S.
On this 22 day of January, 1986, before me Janette L. Murison personally appeared Thomas E. Murison, Janette L. Murison, Philip A. Muscara, Jr. proved to me on the basis of satisfactory evidence to be the persons whose names are subscribed to this instrument, and acknowledged to me that they executed it.

Witness my hand and official seal the day and year first herein above written.

MY COMMISSION EXPIRES 12/18/89

Janette L. Murison
NOTARY PUBLIC IN AND FOR THE COUNTY OF
SANTA CLARA, STATE OF CALIFORNIA.

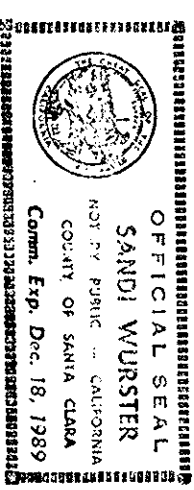

LOT LINE ADJUSTMENT NOTE PARCELS A & B

This map is filed pursuant to Section C12-11 of the Santa Clara County Ordinance Code for the purpose of adjusting lot lines between existing parcels. Approval of this map does not constitute building site approval as to any of the parcels reconfigured as the result of the lot line adjustment. Such parcels may require further approval with applicable County Ordinance prior to development or further development.

RECORDER'S CERTIFICATE

Filed this 21 day of JANUARY, 1986 at 3:35 P.M. in Book 555 of Maps at pages 28-30 at the request of Thomas E. Murison

File No. 8667798
Fee 10.00 ✓

LAURIE KANE, County Recorder
BY F. P. Hunt
DEPUTY

SURVEYOR'S CERTIFICATE

This map was prepared by me or under my direction and is based upon a field survey in conformance with the requirements of the Subdivision Map Act and local ordinance at the request of Thomas E. Murison in June, 1985. I hereby state that this parcel map substantially conforms to the approved or conditionally approved tentative map, if any. I hereby state that all monuments are of the character and occupy the positions indicated or will be set in such positions on or before Dec., 1985, and that such monuments are, or will be sufficient to enable the survey to be retraced.

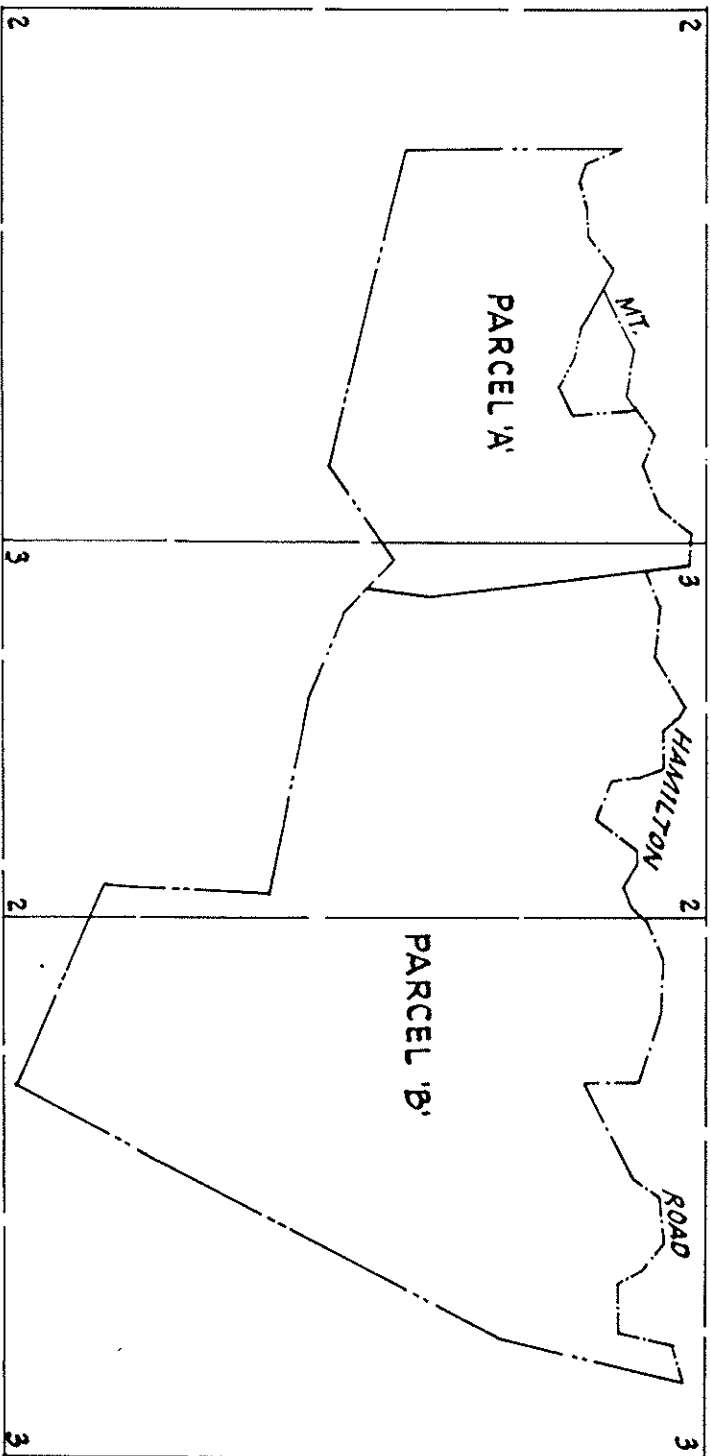

SHEET LOCATION
N.T.S.

COUNTY SURVEYOR'S CERTIFICATE

This map conforms with the requirements of the Subdivision Map Act and Local Ordinance. Pursuant to the provisions of Section C12-133 of the County Ordinance Code, it is hereby ordered that all streets, portions of streets, and easements offered for dedication to the County of Santa Clara are hereby not accepted and all dedications to public use are hereby accepted in behalf of the public for the purposes set forth in the owners certificate.

JAMES F. SIKR, County Surveyor
SIGNED Janette L. Murison, Deputy
date Jan. 22, 1986

LOT LINE ADJUSTMENT
PARCEL MAP
BEING A PORTION OF PUEBLO TRACT NO. 1
AND RANCHO CANADA DE PALA
LYING WITHIN
SANTA CLARA COUNTY, CALIFORNIA



CROSS LAND SURVEYING
2210 MT. PLEASANT ROAD
SAN JOSE, CALIFORNIA 95148

SHEET 1 OF 3

85-26