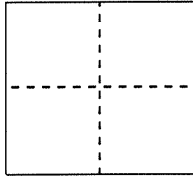

CORNER RECORDDocument Number CR 6748City of Oakland (APN 23-419-36)County of Alameda, CaliforniaBrief Legal Description Found standard monument near 551 Merritt Avenue**CORNER TYPE**

Government Corner ☐ Control ☒
 Meander ☐ Property ☐
 Rancho ☐ Other ☐

Date of Survey October 2, 2014**COORDINATES (Optional)**

N. _____
 E. _____
 Zone _____ NAD27 ☐ NAD83 ☐
 NAD83 Epoch _____
 Elev. _____
 Vert. Datum: NGVD29 ☐ NAVD88 ☐
 Meas. Units: Metric ☐ Imperial ☐

Pre-Construction (water line) Corner Record

Corner - Left as found ☒ Found and tagged ☐ Established ☐ Reestablished ☐ Rebuilt ☐

Identification and type of corner found: Evidence used to identify or procedure used to establish or reestablish the corner:
 Found monument that could be damaged or destroyed by planned water line construction project.

Monument was referenced as shown on page 2. The purpose of this Corner Record is to preserve possible evidence only; no attempt was made to determine the relationship to property, centerline, or right-of-way lines.

A description of the physical condition of the monument as found and as set or reset:

Monument was found in good condition and was referenced with four set reference points representing two intersecting lines as shown on Page 2.

Reference EBMUD Field Book 4560, Page 41/42 (Burke/Waller)

SURVEYOR'S STATEMENT

This Corner Record was prepared by me or under my direction in conformance with
 the Professional Land Surveyor's Act on October 8, 2014

Signed R. Lee Hixson P.L.S. or R.C.E. No. 4806

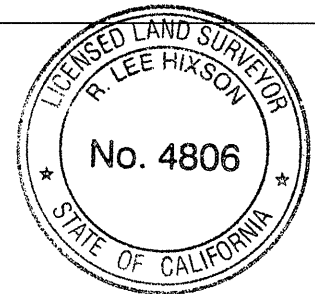
**COUNTY SURVEYOR'S STATEMENT**

This Corner Record was received 10-9-14
 and examined and filed 11-7-14

Signed Russell R. Penland P.L.S. or R.C.E. No. 5726

Title COUNTY SURVEYOR

County Surveyor's Comment: _____

**AR7854**

