

OWNER'S STATEMENT

THE UNDERSIGNED, HEREBY STATES THAT IT IS THE OWNER OF ALL THE LANDS DELINEATED AND EMBRACED WITHIN THE EXTERIOR BOUNDARY LINES UPON THE HEREIN EMBODIED PARCEL MAP ENTITLED "PARCEL MAP 6678" CITY OF PLEASANTON, ALAMEDA COUNTY, CALIFORNIA, CONSISTING OF 2 SHEETS, THIS STATEMENT BEING UPON SHEET 1 THEREOF; THAT SAID OWNER HAS CAUSED SAID MAP TO BE PREPARED FOR RECORD AND CONSENTS TO THE PREPARATION AND RECORDATION OF SAID MAP, AND THAT SAID MAP PARTICULARLY SETS FOURTH AND DESCRIBES ALL THE PARCELS SHOWN ON SAID MAP.

THE AREA MARKED "PRIVATE STORM DRAIN EASEMENT", OR "P.S.D.E.", IS SPECIFICALLY EXCLUDED FROM PUBLIC DEDICATION, BUT IS RESERVED BY SAID OWNER FOR STORM DRAIN PURPOSES INCLUDING CONSTRUCTION, ACCESS, OR MAINTENANCE OF WORKS, IMPROVEMENTS, OR STRUCTURES, WHETHER COVERED OR OPEN, OR THE CLEARING OF OBSTRUCTIONS OR VEGETATION UNDER, UPON, OR OVER SAID EASEMENT.

THE AREA MARKED "PRIVATE SANITARY SEWER EASEMENT", OR "P.S.S.E.", IS SPECIFICALLY EXCLUDED FROM PUBLIC DEDICATION, BUT IS RESERVED BY SAID OWNER FOR SANITARY SEWER PURPOSES INCLUDING CONSTRUCTION, ACCESS, OR MAINTENANCE OF WORKS, IMPROVEMENTS, OR STRUCTURES, WHETHER COVERED OR OPEN, OR THE CLEARING OF OBSTRUCTIONS OR VEGETATION UNDER, UPON, OR OVER SAID EASEMENT.

THE AREA MARKED "WATER LINE EASEMENT", OR "W.L.E.", IS SPECIFICALLY EXCLUDED FROM PUBLIC DEDICATION, BUT IS RESERVED BY SAID OWNER FOR DOMESTIC WATER SERVICES INCLUDING CONSTRUCTION, ACCESS, OR MAINTENANCE OF WORKS, IMPROVEMENTS, OR STRUCTURES, WHETHER COVERED OR OPEN, OR THE CLEARING OF OBSTRUCTIONS OR VEGETATION UNDER, UPON, OR OVER SAID EASEMENT.

THE AREA MARKED "FIRE SERVICE EASEMENT", OR "F.S.E.", IS SPECIFICALLY EXCLUDED FROM PUBLIC DEDICATION, BUT IS RESERVED BY SAID OWNER FOR FIRE SERVICES INCLUDING CONSTRUCTION, ACCESS, OR MAINTENANCE OF WORKS, IMPROVEMENTS, OR STRUCTURES, WHETHER COVERED OR OPEN, OR THE CLEARING OF OBSTRUCTIONS OR VEGETATION UNDER, UPON, OR OVER SAID EASEMENT.

THE AREA MARKED "UNDERGROUND GAS AND ELECTRIC EASEMENT", OR "U.G. & E.E.", IS SPECIFICALLY EXCLUDED FROM PUBLIC DEDICATION, BUT IS RESERVED BY SAID OWNER FOR GAS AND ELECTRIC SERVICES INCLUDING CONSTRUCTION, ACCESS, OR MAINTENANCE OF WORKS, IMPROVEMENTS, OR STRUCTURES, WHETHER COVERED OR OPEN, OR THE CLEARING OF OBSTRUCTIONS OR VEGETATION UNDER, UPON, OR OVER SAID EASEMENT.

THIS MAP SHOWS ALL EASEMENTS ON THE PREMISES, OR OF RECORD.

AS OWNERS: R AND B PROPERTIES, INC., A CALIFORNIA CORPORATION

BY *M. A. Miller*
PRESIDENT ASSISTANT SECRETARY

OWNER'S ACKNOWLEDGEMENT

STATE OF California) SS
COUNTY OF Contra Costa

ON April 11, 1994, BEFORE ME, MARGARET A. MILLER
A NOTARY PUBLIC IN AND FOR SAID COUNTY AND STATE, PERSONALLY
APPEARED Thomas H. Terrill
PERSONALLY KNOWN TO ME (OR PROVED TO ME ON THE BASIS OF
SATISFACTORY EVIDENCE) TO BE THE PERSONS WHOSE NAMES ARE
SUBSCRIBED TO THE WITHIN INSTRUMENT AND ACKNOWLEDGED TO ME THAT
THEY EXECUTED THE SAME IN THEIR AUTHORIZED
CAPACITIES, AND THAT BY THEIR SIGNATURES ON THE
INSTRUMENT THE PERSON(S), OR THE ENTITY ON BEHALF OF WHICH THE
PERSON(S) ACTED, EXECUTED THE INSTRUMENT.

WITNESS MY HAND

SIGNATURE *Margaret A. Miller*
PRINTED NAME MARGARET A. MILLER
NOTARY PUBLIC IN AND FOR THE COUNTY OF
CONTRA COSTA, STATE OF CALIFORNIA
MY COMMISSION EXPIRES: June 15, 1997
COUNTY OF PRINCIPAL PLACE OF BUSINESS: Contra Costa

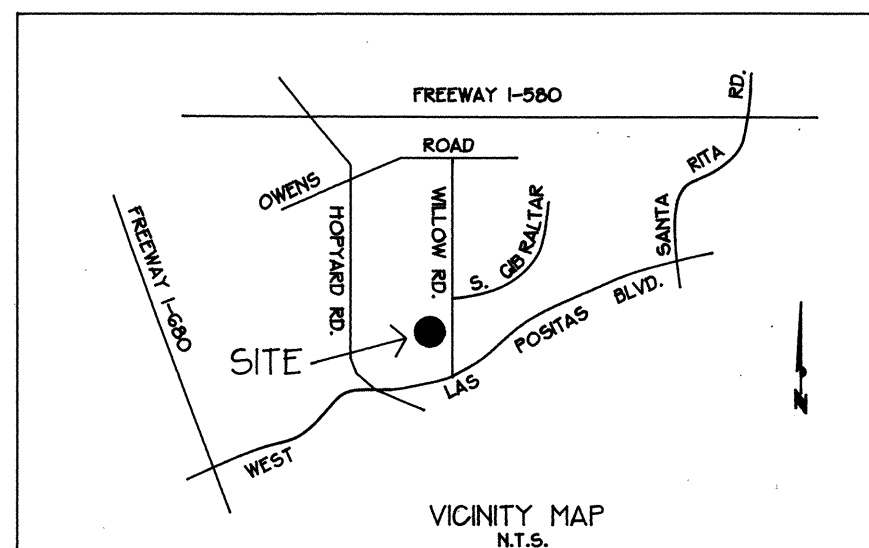
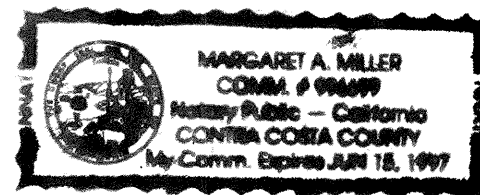

PARCEL MAP 6678

LOT 31B AS SHOWN ON AMENDED PARCEL MAP NO. 4308 FILED NOVEMBER 23, 1987, IN BOOK 172 OF MAPS AT PAGE 88, ALAMEDA COUNTY RECORDS.

CITY OF PLEASANTON ALAMEDA COUNTY CALIFORNIA
MS 93-05

DK ASSOCIATES INC.

CIVIL ENGINEERING-PLANNING-SURVEYING
1440 MARIA LANE, SUITE 200
WALNUT CREEK, CALIFORNIA 94596
JANUARY, 1994

CITY ENGINEER'S STATEMENT

I, RANDALL A. LUM, CITY ENGINEER FOR THE CITY OF PLEASANTON, COUNTY OF ALAMEDA, STATE OF CALIFORNIA, DO HEREBY STATE THAT I HAVE EXAMINED THE HEREIN EMBODIED PARCEL MAP ENTITLED "PARCEL MAP 6678" CITY OF PLEASANTON, COUNTY OF ALAMEDA, CALIFORNIA CONSISTING OF 2 SHEETS, THIS STATEMENT BEING UPON SHEET 1 THEREOF; THAT THE SUBDIVISION AS SHOWN UPON SAID MAP IS SUBSTANTIALLY THE SAME AS SAID SUBDIVISION APPEARED ON THE TENTATIVE MAP OF PARCEL MAP 6687, AND ANY APPROVED ALTERATION THEREOF, CONFORMS WITH THE REQUIREMENTS OF THE SUBDIVISION MAP ACT AND LOCAL ORDINANCE, AND I AM SATISFIED THAT THE MAP IS TECHNICALLY CORRECT.

IN WITNESS WHEREOF, I HAVE SET MY HAND THIS 1st DAY OF June

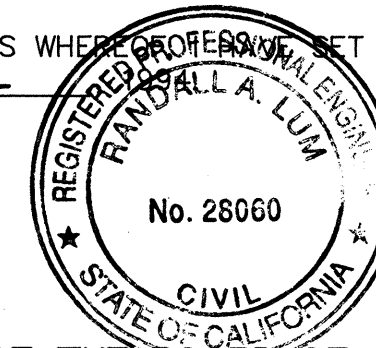

R. Lum
BY RANDALL A. LUM, RCE NO. 28060
EXPIRATION DATE: 3/31/95
CITY ENGINEER
CITY OF PLEASANTON, CALIFORNIA

CLERK OF THE BOARD OF SUPERVISORS STATEMENT

I, WILLIAM MEHRWEIN, CLERK OF THE BOARD OF SUPERVISORS OF THE COUNTY OF ALAMEDA, STATE OF CALIFORNIA, DO HEREBY STATE THAT CERTIFICATES HAVE BEEN FILED AND DEPOSITS HAVE BEEN MADE IN CONFORMANCE WITH THE REQUIREMENTS OF SECTIONS 66492 AND 66493 OF THE GOVERNMENT CODE OF THE STATE OF CALIFORNIA.

WILLIAM MEHRWEIN
CLERK OF THE BOARD OF
SUPERVISORS OF THE COUNTY OF
ALAMEDA, STATE OF CALIFORNIA

BY: *Rosalinda K. Caballero* November 22, 1994
DEPUTY COUNTY RECORDER DATED:

ENGINEER'S STATEMENT

THIS MAP WAS PREPARED BY ME OR UNDER MY DIRECTION AND IS BASED UPON A FIELD SURVEY IN CONFORMANCE WITH THE REQUIREMENTS OF THE SUBDIVISION MAP ACT AND LOCAL ORDINANCE AT THE REQUEST OF R AND B PROPERTIES ON DECEMBER 24, 1993. I HEREBY STATE THAT THIS PARCEL MAP SUBSTANTIALLY CONFORMS TO THE APPROVED VESTING TENTATIVE MAP.

Robert M. Duch
ROBERT M. DUCH, RCE NO. 29123
EXP. DATE MARCH 31, 1995

DATE: 4/28/94

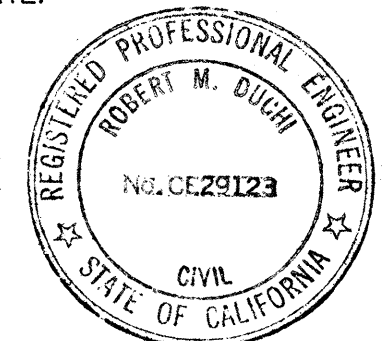

COUNTY RECORDER'S STATEMENT

FILED THIS 23rd DAY OF NOVEMBER, 1994, AT 3:28 p.m. IN
BOOK 215 OF MAPS AT PAGES 99-100 AT THE REQUEST OF
FIRST AMERICAN TITLE GUARANTY COMPANY.

FEE: 10.00 SERIES NO. 94-36752

COUNTY RECORDER IN AND FOR THE
COUNTY OF ALAMEDA, STATE OF
CALIFORNIA

BY: *Edna Perani*
DEPUTY COUNTY RECORDER